

RADIAL AIR SEPARATOR

GVSQ

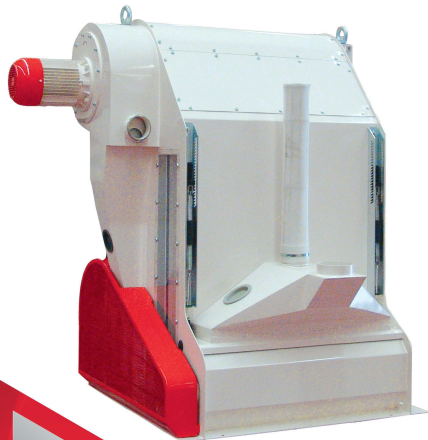

Radial air separator designed for separating small density and unwanted grains and very small parts of grains shell, peel ect. from wheat, corn, barley and all leguminosae which have high density by the help of air circulation. Radial Air Separator is used in silo for cleaning process or before grinding sections. After grains enter into sink which have vibrational movement, they distribute smoothly and move straight through the air canal section. There is air flow against grain flow direction in the air canal section. This opposite current provide to separate light grains and low density particles from grains. Since the air requirement is minimum, due to closed-circuit operation of the machine, it operates via aspirator on the machine. Ø 100 mm. Pipe on the aspirator should be connected to the interring air system. When air canal section is calibrated at two different points, optimum productivity is achieved. It is possible to see inside of the machine because the machine is equipped with plexiglas windows. This machine is unique since has a compact system contains turbine and cyclone.

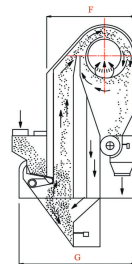
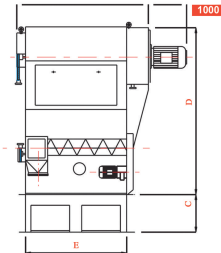
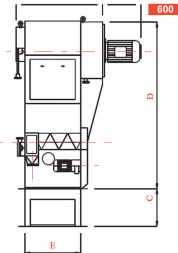

TYPE	CAPACITY t/h		Air Need m³/min		Electrical Motor			Reducer Motor			Approx Weight Kg.		
	1.Cleaning	2.Cleaning	1.Cleaning	2.Cleaning	CEI Standard	Kw	rpm	CEI Standard	Kw	rpm	Net	Gross	Package m³
600	40	9	8	4	AGM 90 L2	2,2	3000	NR 102-80/46	0,75	256	530	670	3,9
1000	66	16	10	6	AGM 112 M2	4	3000	NR 102-80/46	0,75	256	595	770	5,2

TYPE	A	B	C	D	E	F	G
GVSQ							
600	923	280	500	1729	600	902	1134
1000	1313	330	500	1729	990	902	1134

GPS

ASCOM MAKINA SAN. Tic.Ltd. Sti

Manufacturing Production Lines

GPS-ASCOM

