

ROLLER MILL OPTIMUS

GDMK

Roller miller is one of the most important machine in the modern flour plants to produce flour. To choose Roller Mill is directly related with the quality and amount of the product. At the grinding system of the Roller Mill, the forces of breaking, crushing and pressure forces are applied together. It is a good & available system to have the required size of products. Generally they are state as Breaking Roller Mill & Liso Roller Mill. The surface of the Breaking Roller Mill cylinders are grooved, and Liso Roller Mill cylinders surfaces are smooth. To choose Liso or Breaking Roller Mill is clarified according to the diagram. The duty of the feeding cylinders mounted on roller mill, to transfer the grinded products between the cylinders homogeneously.

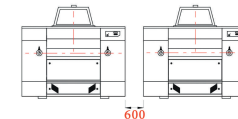
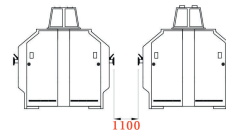
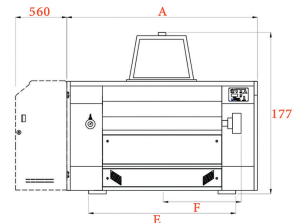
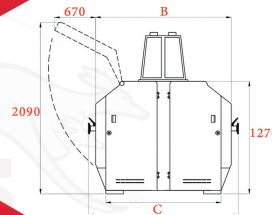
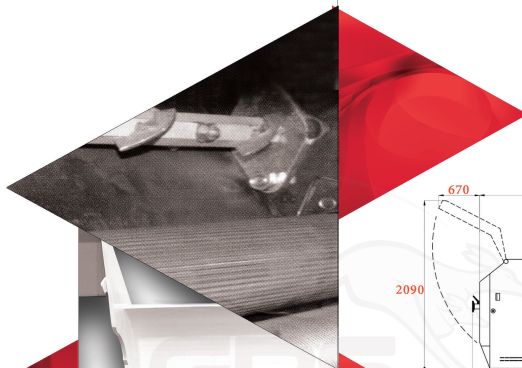

TYPE	DIMENSIONS (mm)								Approx Weight Kg.		
	O DIA.	L mm.	A	B	C	D	E	F	Net	Gross	Package m ³
GDMK	250	1000	1900	1480	1300	1680	1410	840	3200	3680	5,6
		1250	2150	1480	1300	1680	1660	965	3600	4140	6,4
		1500	2400	1480	1300	1680	1910	1090	4150	4772	8,4
GDMK	300	1000	1900	1530	1300	1730	1410	840	3650	4197	5,8
		1250	2150	1530	1300	1730	1660	965	4250	4888	6,6